



**3.0T**  
Rated Load Capacity



**1.6m/s**  
Max. Safety Driving Speed



**125mm**  
Fork Lifting Height



**2600mm**  
Min. Stacking Aisle Width

# VNT30(VL)-01

## PALLET JACK AGV

By using 3D SLAM navigation and 3D Laser perception module on pallet jack AGV, the project implementation period is shortened and the AGV has high reliability; The AGV has light body weight with customizable forks and supporting legs based on different scenarios, which provides great flexibility, and strong adaptability; The pallet jack AGV is capable of working between different building floors.



# VNT30(VL)-01

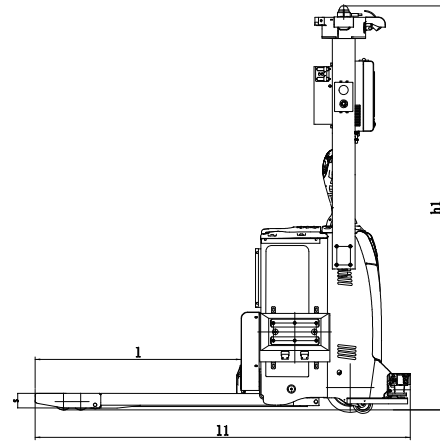
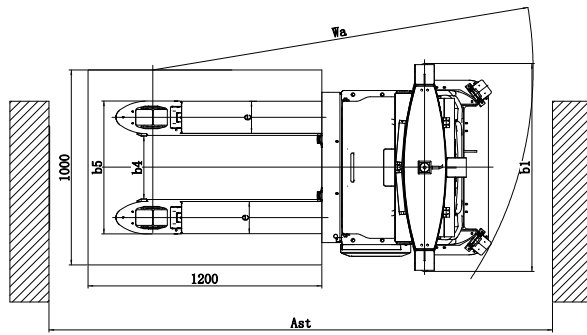

## TECHNICAL SPECIFICATIONS

Body Weight	650kg (1433lb)	Fork Lifting Height	125mm (4.92in)
Vehicle Dimensions(l1/b1/h1)	1925x900x2075mm (75.79x35.43x81.69in)	Rated Load Capacity	3000kg (6613.87lb)
ForkDimensions(l/e/s)	1050x165x55mm (41.34x6.50x2.17in)	Load Center Distance	600mm (23.62in)
Optional Fork Dimensions Series	1150/1250/1350/1500/1600/1800mm (45.28x49.21x53.15x59.06x62.99x70.87in)	Min. Turning Radius	1950mm (76.77in)
Fork Outer Width	560/680mm (22.05/26.77in)	Stacking Accuracy	$\pm 10\text{mm}/\pm 0.5^\circ$ ( $\pm 0.39\text{in}/\pm 0.5^\circ$ )
Fork Inner Width	210/330mm (8.27/12.99in)	Operation Mode	Automatic / Stand up Manual
Positioning Method	3D SLAM navigation	Battery Type	Lithium iron phosphate battery
Perception Method	3D Laser scanner	Voltage/Battery Capacity	24V/270Ah
Goods Pick-up Self-adaptability	$\pm 100\text{mm}/\pm 10^\circ$ ( $\pm 3.94\text{in}/\pm 10^\circ$ )	Charging Mode	Manual/ Automatic Charging

## MOTION PERFORMANCE

Straight Forward Speed (Full-Load/Empty-Load)	1.6m/s, 1.6m/s (3.58mph, 3.58mph)	Backward Turning Speed (Full-Load/Empty-Load)	0.3m/s, 0.6m/s (0.67mph, 1.34mph)
Straight Backward Speed (Full-Load/Empty-Load)	0.6m/s, 0.6m/s (1.34mph, 1.34mph)	Lifting Up Speed (Full-Load/Empty-Load)	24mm/s, 35mm/s (0.05mph, 0.08mph)
Forward Turning Speed (Full-Load/Empty-Load)	0.3m/s, 0.6m/s (0.67mph, 1.34mph)	Lifting Up Speed (Full-Load/Empty-Load)	67mm/s, 66mm/s (0.15mph, 0.15mph)

## ENVIRONMENTAL REQUIREMENT

Min. Stacking Aisle Width (Pallet Size L*W:1200*1000mm, Across Forks On Width)	2600mm (102.36in)	Ground Flatness	$\pm 5\text{mm}/\text{m}^2$ ( $\pm 0.20\text{in}/\text{m}^2$ )
Min. Turning Aisle Width (Pallet Size L*W:1200*1000mm, Across Forks On Width)	2150mm (84.65in)	Max. Climbing Capability (Full-Load/Empty-Load)	5%, 5% (3°, 3°)
Working Temperature	-5°C~40°C	Max. Groove Width	30mm (1.18in)
Working Humidity	20%~95%	Max. Step Height	10mm (0.39in)

## SAFETY PROTECTION

Front	Laser Scanner Protection + Anti-Collision Bumper	Side	Laser Scanner Protection + Anti-Collision Bumper
Rear	Laser Scanner Protection + Non-Contact Sensor	Other	Emergency Stop Button + Acousto-Optic Alarm
Top	Photoelectric Sensor + Ultrasound Scanner		

\* Customizable fork length, fork outer width, and supporting legs outer width; Other available options: 5G communication, battery heating, safety anti-collision bumper, UWB safety system, barcode scanner, dash cam, RFID reader, etc.

Due to products upgrade, the specifications and parameters may be changed without notice. Please consult the sales for details.